

The T3 GYS AUTO is a three phase MIG-MAG, with torch connector, recommended for welding steel, stainless steel, aluminium and for MIG brazing of high-tensile strength steels with CuSi and CuAl wires (ideal for car body repairs).

Synergic Mode

The machine determines the optimum wire speed by selecting :

- the type of wire
- the wire diameter
- the welding current



Spool gun

Upgradeable - the T3 GYS AUTO can be fitted with a Spool Gun torch. This motorised torch is suitable for ø100mm wire reels of aluminium, stainless steel, copper and steel in ø0.8mm.

- Ideal for soft wire such as the AISi5 or AISi12 (recommended for car body repairs)
- Ease of use : adjusting the wire speed on the Spool Gun torch directly.
- The machine is delivered with a balancing system to support the Spool Gun torch.

4 Drive rolls motor

Suitable for ø200mm and ø300mm wire reels (15kg max).

Saving welding parameters

Memory save feature for each torch and activation of the 'last used' welding parameters (wire diameter, wire type and mode).



Accessories

- Delivered with:
- 2 Steel torches 150A - 3m
 - 1 Spool Gun
 - 1 Earth clamp - 3m
 - 1 Balancing system (regulator not included)

+ PRODUIT

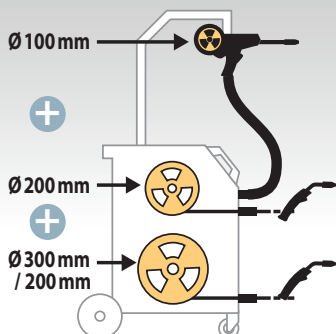



2 torches, 2 integrated wire feeder + 1 Spool Gun - The T3 GYS AUTO is a multifunctional and flexible machine designed to weld 3 different type of wire or diameter at the same time. It's saving time by avoiding disassembling the torch and changing the wire reel for another job.

Capable of welding:

- Soft wires: as ALSi and CuAl necessary for welding HLE/THLE metal sheets
- Aluminium wires
- Steel wires

CE - EN 60974-1

50/60hz	10A	min▷max 15▷200A	ø mm 0.6-1.0	ømm				équipé d'origine / original equipment / originalausstattung / equipamiento de fabrica		EN60974-1 (40°C)		cm/kg 60x90x90 72	Protected & compatible POWER GENERATOR (+/- 15%)	Spool Gun Included
				100	200	300		IA (60%)	X% (I2 max)					
400V	10A	15▷200A	0.6-1.0		✓	✓		2x0.8	110A	150A 25%	60x90x90 72	5 kVA	Spool Gun Included	
230/400V				0.6-0.8	0.8-1.0									